

THE PENNSYLVANIA CONVENTION CENTER FLOOR PLANS

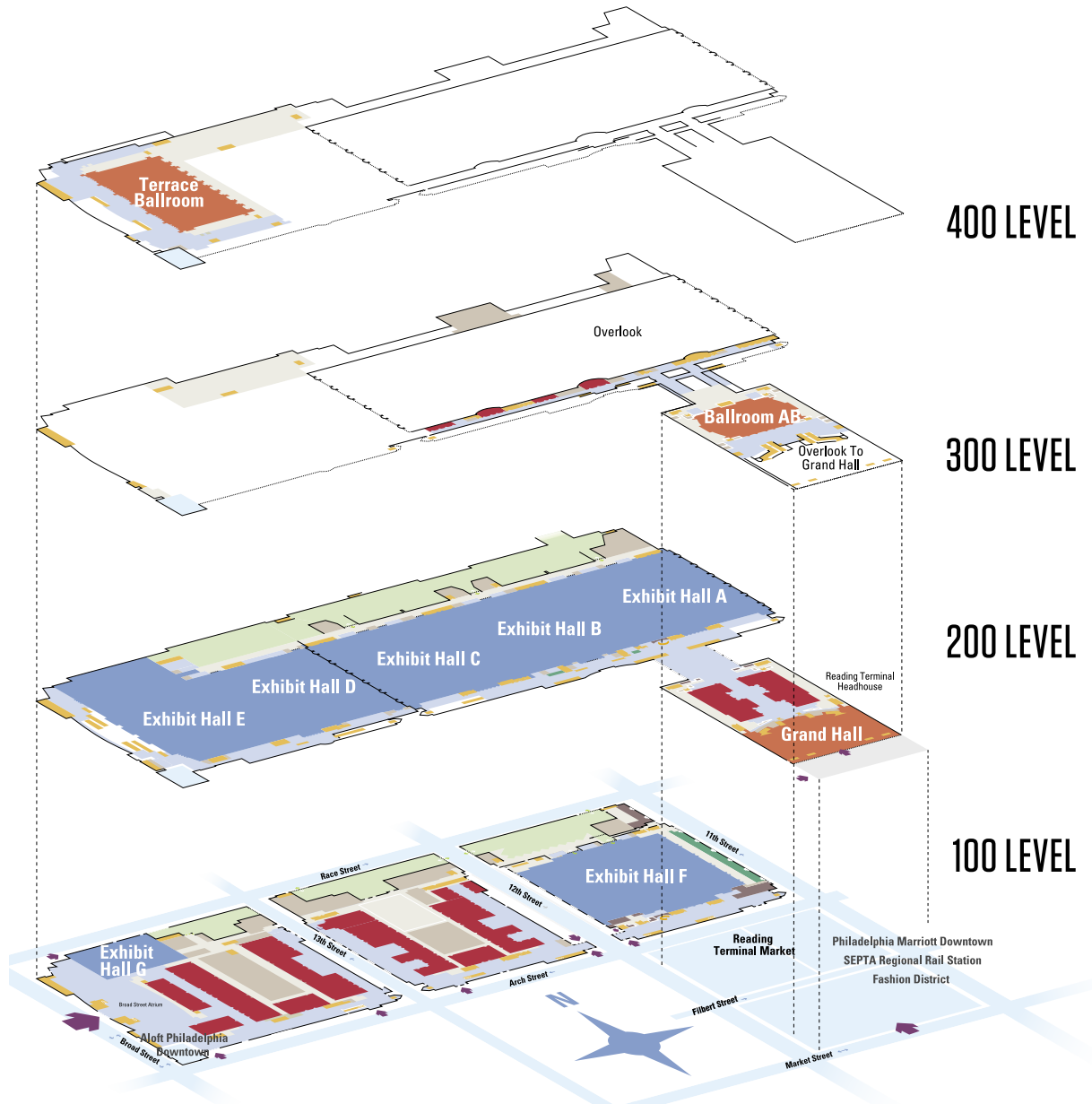

KEY

- | | |
|-----------------------------|-----------------------|
| Entrances | Concession Stand |
| Exhibit Halls | Dressing Rooms |
| Meeting Rooms | Elevator |
| Ballrooms | Freight Elevator |
| Public Areas | Fire Hose Connection |
| Shops | Stairs/Emergency Exit |
| Stairs, Elevator, Escalator | Restrooms |
| Loading Dock | Ticket Offices |
| House Storage | Columns |
| Offices | Water Fountain |
| Back of House | AED/Medical |
| | Mamava Nursing Pod |

100 LEVEL | STREET ACCESS



KEY

- Entrances
- Exhibit Halls
- Meeting Rooms
- Ballrooms
- Public Areas
- Shops
- Stairs, Elevator, Escalator
- Loading Dock
- House Storage
- Offices
- Back of House
- C Concession Stand
- D Dressing Rooms
- E Elevator
- FE Freight Elevator
- F Fire Hose Connection
- SE Stairs/Emergency Exit
- R Restrooms
- T Ticket Offices
- Columns
- Water Fountain
- AED/Medical
- Mamava Nursing Pod

200 LEVEL | EXHIBIT HALL

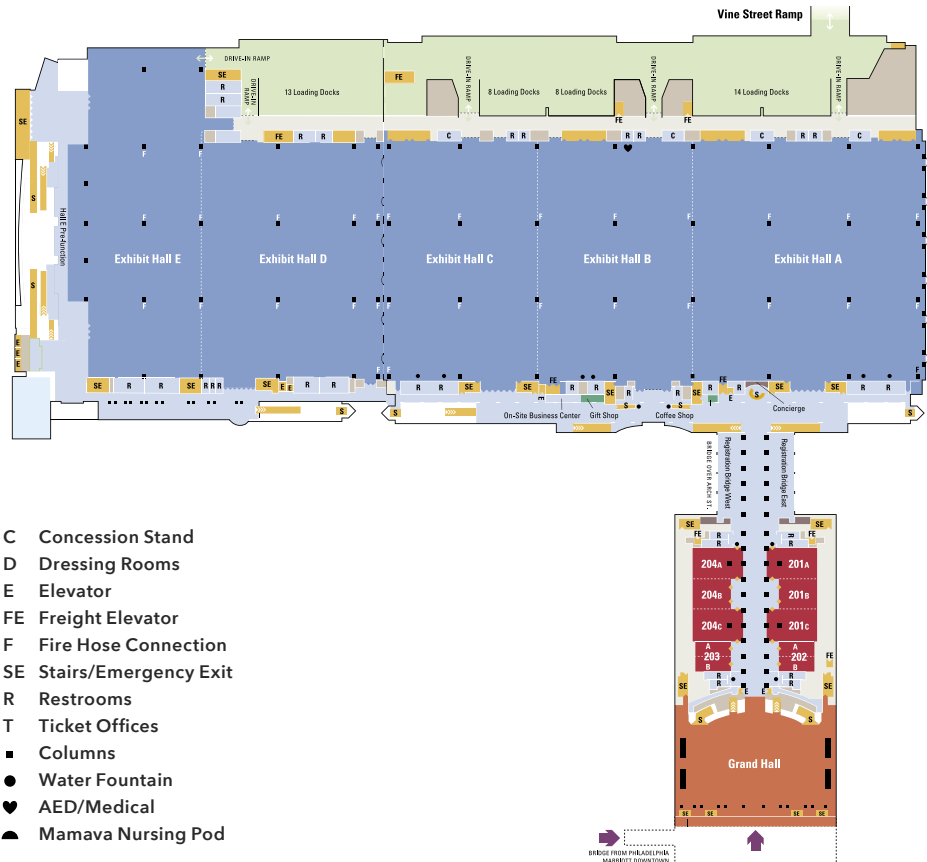

KEY

- Entrances
- Exhibit Halls
- Meeting Rooms
- Ballrooms
- Public Areas
- Shops
- Stairs, Elevator, Escalator
- Loading Dock
- House Storage
- Offices
- Back of House
- C Concession Stand
- D Dressing Rooms
- E Elevator
- FE Freight Elevator
- F Fire Hose Connection
- SE Stairs/Emergency Exit
- R Restrooms
- T Ticket Offices
- Columns
- Water Fountain
- AED/Medical
- Mamava Nursing Pod

100 LEVEL

GETTING IN ON THE GROUND FLOOR



A GOLD-CERTIFIED LEED FACILITY

100 LEVEL MEETING ROOMS								
Meeting Room	Gross sq ft	Width	Length	Ceiling Height	Banquet	Class Room	Theater	Hollow Square
100-A	450	18'	25'	11'	20	24	48	16
100-B	450	18'	25'	11'	20	24	48	16
101	450	18'	25'	11'	20	24	46	16
102-A	1,540	37'	38'	11'	90	72	162	40
102-B	770	18'	38'	11'	30	42	80	32
102-AB	2,146	58'	38'	11'	150	112	256	50
103-A	3,036	39'	76'	17'	180	168	378	64
103-B*	3,036	39'	76'	17'	160	152	353	70
103-AB	6,080	80'	76'	17'	340	376	775	75
103-BC	6,080	80'	76'	17'	340	376	775	75
103-C	3,036	39'	76'	17'	180	168	378	64
103-ABC	9,044	119'	76'	17'	560	600	1,060	80
104-A	986	29'	34'	11'	40	48	108	30
104-B	986	29'	34'	11'	40	48	108	30
104-AB	1,972	59'	34'	11'	100	124	238	56
105-A	802	19'	38'	13'	40	42	80	32
105-B	2,406	59'	38'	13'	150	144	272	70
105-AB	3,081	79'	38'	13'	210	192	368	72
106-A	825	19'	39'	11'	40	42	80	30
106-B	825	19'	39'	11'	40	42	80	30
106-AB	1,521	39'	39'	11'	90	84	180	40
107-A	802	19'	39'	13'	40	48	80	30
107-B	2,406	59'	39'	13'	150	144	272	70
107-AB	3,081	79'	39'	13'	180	192	368	72
108-A	3,165	45'	66'	17'	190	208	360	64
108-B	3,165	45'	66'	17'	190	208	360	64
108-AB	6,006	91'	66'	17'	380	368	726	88
109-A	802	19'	39'	13'	40	42	80	32
109-B	2,406	59'	39'	13'	150	144	272	56
109-AB	3,081	79'	39'	13'	210	192	368	72
110-A	825	19'	39'	11'	40	42	80	30
110-B	825	19'	39'	11'	40	42	80	30
110-AB	1,521	39'	39'	11'	90	84	180	40
111-A	802	19'	39'	13'	40	42	80	32
111-B	2,406	59'	39'	13'	150	144	272	70
111-AB	3,081	79'	39'	13'	210	192	368	70
112-A	986	29'	34'	12'	40	48	108	30
112-B	986	29'	34'	12'	40	48	108	30
112-AB	1,972	58'	34'	12'	100	120	238	56
113-A	3,036	39'	76'	17'	180	168	378	70
113-B*	3,036	39'	76'	17'	160	152	352	70
113-C	3,036	39'	76'	17'	180	168	378	70
113-AB	6,004	59'	76'	17'	340	376	651	75
113-BC	6,004	59'	76'	17'	340	376	651	75
113-ABC	9,044	118'	76'	17'	560	600	1,060	80

100 LEVEL MEETING ROOMS								
Meeting Room	Gross sq ft	Width	Length	Ceiling Height	Banquet	Class Room	Theater	Hollow Square
Michael A. Nutter Theatre	6,300	81'3"	58'6"	17' Low 21' High		600 Fixed-Seating		Stage 58'W x 14'D
115-A	2,964	39'	76'	18'	180	156	360	64
115-B*	2,964	39'	76'	18'	150	160	322	48
115-C	2,964	39'	76'	18'	180	156	360	64
115-AB	6,004	79'	76'	18'	260	320	656	75
115-BC	6,004	79'	76'	18'	260	320	656	75
115-ABC	9,044	119'	39'	18'	540	608	1050	80
116	2,655	59'	46'	12'	150	192	280	56
117	2,655	59'	46'	12'	150	192	280	56
118-A	2,964	39'	76'	18'	180	156	360	64
118-B*	2,964	40'	76'	18'	150	96	322	48
118-C	2,964	39'	76'	18'	180	156	360	64
118-AB	6,004	79'	76'	18'	260	320	656	75
118-BC	6,004	79'	76'	18'	260	320	656	75
118-ABC	9,044	76'	119'	18'	340	608	1050	80
119-A	3,082	46'	67'	18'	190	184	340	64
119-B	3,082	46'	67'	18'	190	184	340	64
119-AB	6,164	91'	67'	18'	380	368	736	88
120-A	2,379	39'	59'	18'	120	120	270	56
120-B	2,379	39'	59'	18'	120	120	270	56
120-C	2,379	39'	59'	18'	120	120	270	56
120-AB	4,661	79'	59'	18'	240	280	546	75
120-BC	4,661	79'	59'	18'	240	280	546	75
120-ABC	7,259	119'	59'	18'	400	480	858	80
121-A	2,379	39'	59'	18'	120	120	270	56
121-B	2,379	39'	59'	18'	120	120	270	56
121-C	2,379	39'	59'	18'	120	120	270	56
121-AB	4,661	79'	59'	18'	240	280	546	70
121-BC	4,661	79'	59'	18'	240	280	546	70
121-ABC	7,259	119'	59'	18'	400	480	858	80
122-A	2,379	39'	59'	18'	120	120	270	56
122-B	3,600	39'	59'	18'	200	200	392	64
122-AB	6,040	99'	59'	18'	320	320	672	88
123	2,596	59'	43'	12'	150	140	280	56
124	2,596	59'	43'	12'	150	140	280	56
125	2,596	59'	43'	12'	150	140	280	56
126-A	3,540	60'	59'	18'	200	200	420	64
126-B	1,830	30'	59'	18'	100	88	224	56
126-AB	5,428	92'	59'	18'	280	320	672	88

100 LEVEL EXHIBIT HALLS										
Room	Gross sq ft	Width	Length	Ceiling Height	Columns	10 x 10 Exhibits	Banquet**	Theater	Max Door Size	Loading Docks
Hall F*	125,000	368'	340'	15' Low	60'	477	5,240	9,200	24' x 16'	8
Hall G*	26,000	190'	179'	14' Low	60'	82	1,080	2,200	24' x 14'	4
Broad Street Atrium	23,400	90'	260'	113'	N/A	N/A	N/A	N/A	N/A	N/A

Capacities shown are maximum with no furniture or equipment.
 These numbers do not account for A/V equipment or staging that may impact the capacity.
 * Rooms with columns ** Rounds of 10