

THE PENNSYLVANIA CONVENTION CENTER FLOOR PLANS

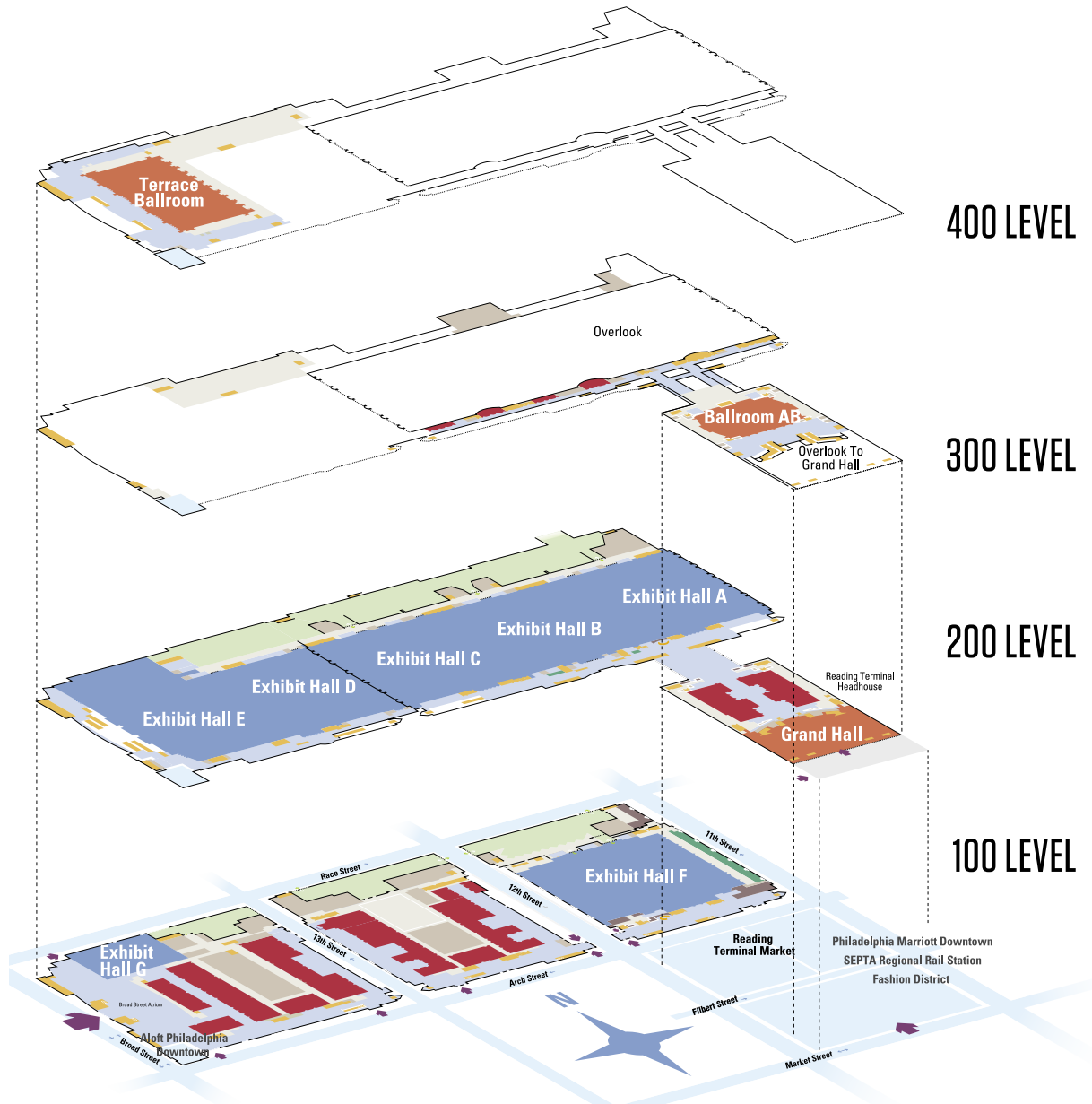

KEY

- | | |
|-----------------------------|-----------------------|
| Entrances | Concession Stand |
| Exhibit Halls | Dressing Rooms |
| Meeting Rooms | Elevator |
| Ballrooms | Freight Elevator |
| Public Areas | Fire Hose Connection |
| Shops | Stairs/Emergency Exit |
| Stairs, Elevator, Escalator | Restrooms |
| Loading Dock | Ticket Offices |
| House Storage | Columns |
| Offices | Water Fountain |
| Back of House | AED/Medical |
| | Mamava Nursing Pod |

100 LEVEL | STREET ACCESS



200 LEVEL | EXHIBIT HALL

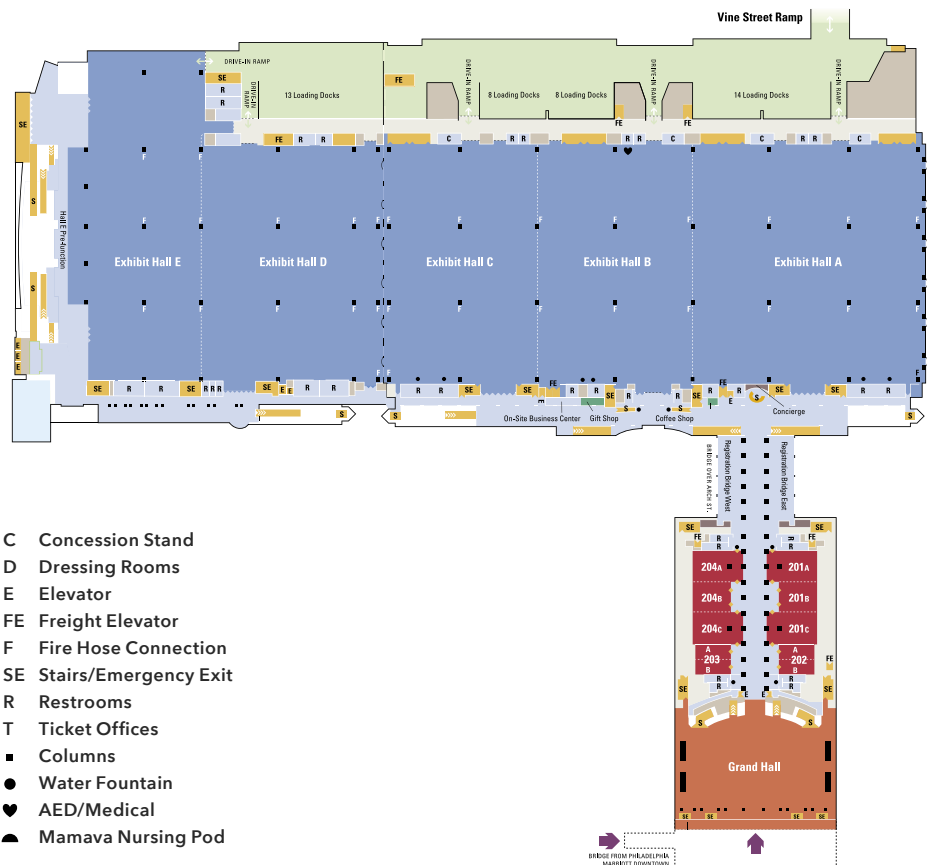

200 LEVEL

200 LEVEL MEETING ROOMS

Meeting Room	Gross sq ft	Width	Length	Ceiling Height	Banquet	Class Room	Theater	Hollow Square
201-A *	3,713	48'	79'	20'	200	200	408	64
201-B	2,891	49'	59'	20'	180	176	416	56
201-C *	3,713	49'	79'	20'	200	200	408	64
201-AB	7,426	100'	79'	20'	340	344	712	80
201-BC	7,426	100'	79'	20'	340	344	712	80
201-ABC	11,771	149'	79'	20'	560	576	1,224	90
202-A	1,450	24'	57'	16'	80	88	143	48
202-B	1,450	24'	57'	16'	80	88	143	48
202-AB	2,793	49'	57'	16'	160	160	360	56
203-A	1,450	24'	57'	16'	80	88	143	48
203-B	1,450	24'	57'	16'	80	88	143	48
203-AB	2,793	49'	57'	16'	160	160	360	56
204-A *	3,713	49'	79'	20'	200	200	408	64
204-B	2,891	49'	59'	20'	180	176	416	56
204-C *	3,713	49'	79'	20'	200	200	408	64
204-AB	7,426	99'	79'	20'	340	344	712	75
204-BC	7,426	99'	79'	20'	340	344	712	75
204-ABC	11,771	149'	79'	20'	560	576	1,224	80

BRIDGE OVER ARCH STREET

9,300 sq ft

GRAND HALL

Gross sq ft	Width	Length	Ceiling Height	Columns	10 x 10 Exhibits	Theater	Max Door Size	Loading Docks
34,960	152'	230'	90' low	N/A	N/A	N/A	7'10" x 7'9"	N/A

200 LEVEL EXHIBIT HALLS

Room	Gross sq ft	Width	Length	Ceiling Height	Columns	10 x 10 Exhibits	Banquet**	Theater	Max Door Size	Loading Docks
Hall A *	135,000	370'	360'	30' low	120'	658	7,080	10,000	25' x 16'	14
Hall B *	90,000	370'	240'	30' low	120'	436	4,080	6,000	25' x 16'	8
Hall C *	90,000	370'	240'	30' low	120'	436	4,080	6,000	25' x 16'	6
Hall D *	109,000	294'	380'	29' low	120'	450	5,560	9,310	25' x 16'	8
Hall E *	104,000	221'	518'	29' low	120'	400	5,210	8,900	25' x 16'	5

Capacities shown are maximum with no furniture or equipment.
 These numbers do not account for A/V equipment or staging that may impact the capacity.
 * Rooms with columns ** Rounds of 10



528,000 SQUARE FEET OF OPEN EXHIBIT SPACE ON THIS FLOOR ALONE.



ELEVATED SECOND-LEVEL LOADING DOCK ALLOWS TRACTOR TRAILERS TO DRIVE STRAIGHT UP TO THE EXHIBIT LEVEL.



THE GRAND HALL IN THE RESTORED TRAIN SHED OFFERS A SOARING, INSPIRING SPACE SECOND TO NONE IN MAJOR CONVENTION FACILITIES.